

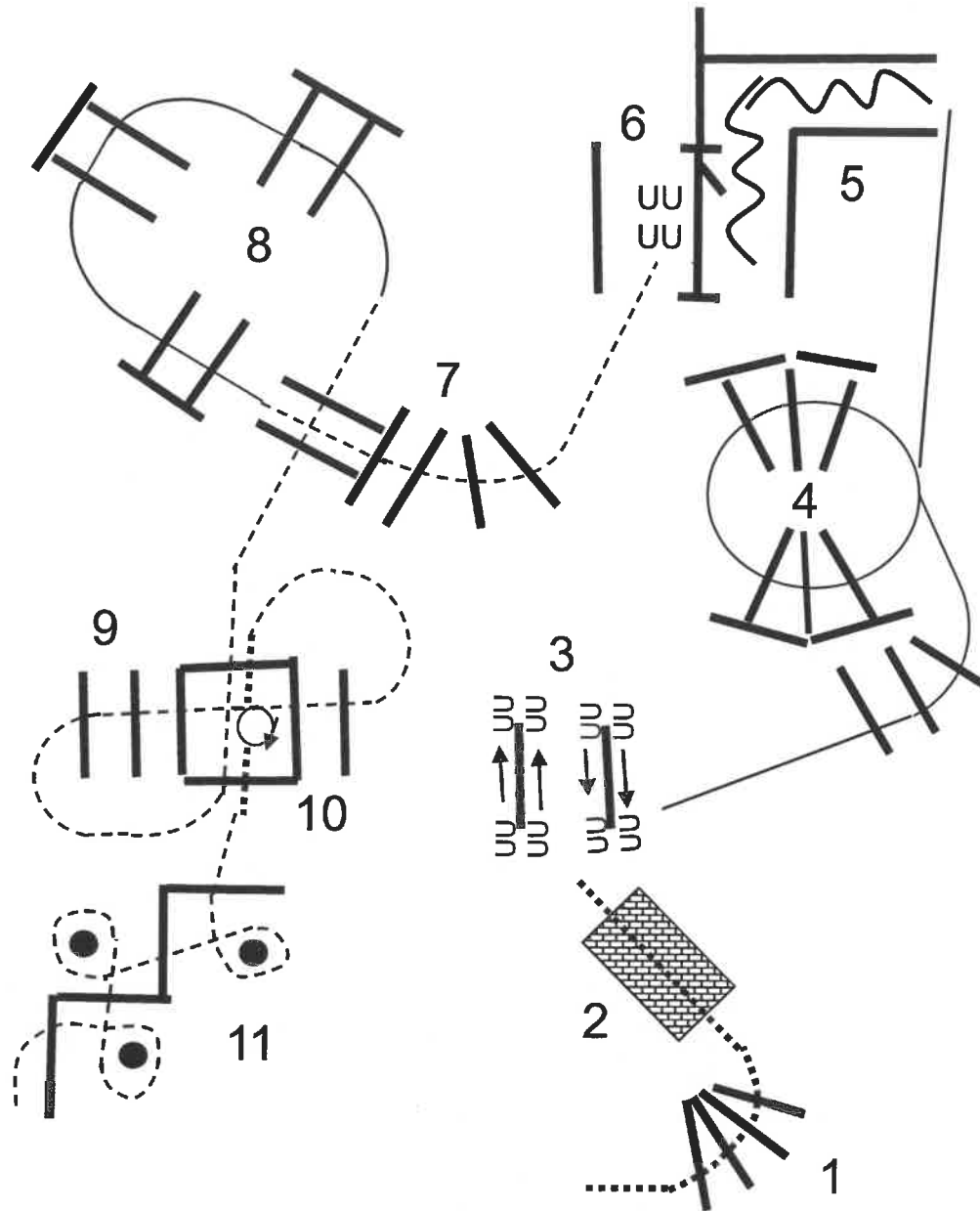





# TRAIL OPEN - DERBY



- 1 walk over
- 2 walk bridge
- 3 side pass left and right
- 4 lope over left lead
- 5 back up
- 6 gate
- 7 jog over
- 8 lope over right lead
- 9 jog over
- 10 walk in - 360° right - walk out
- 11 jog serpentine

 Lope / Galop  
 Jog  
 Walk / Pas  
 Marker -/cône

 Extended Lope / Galop allongé  
 Extended Jog / Trot  
 Turn / pivot  
 Backup / reculer

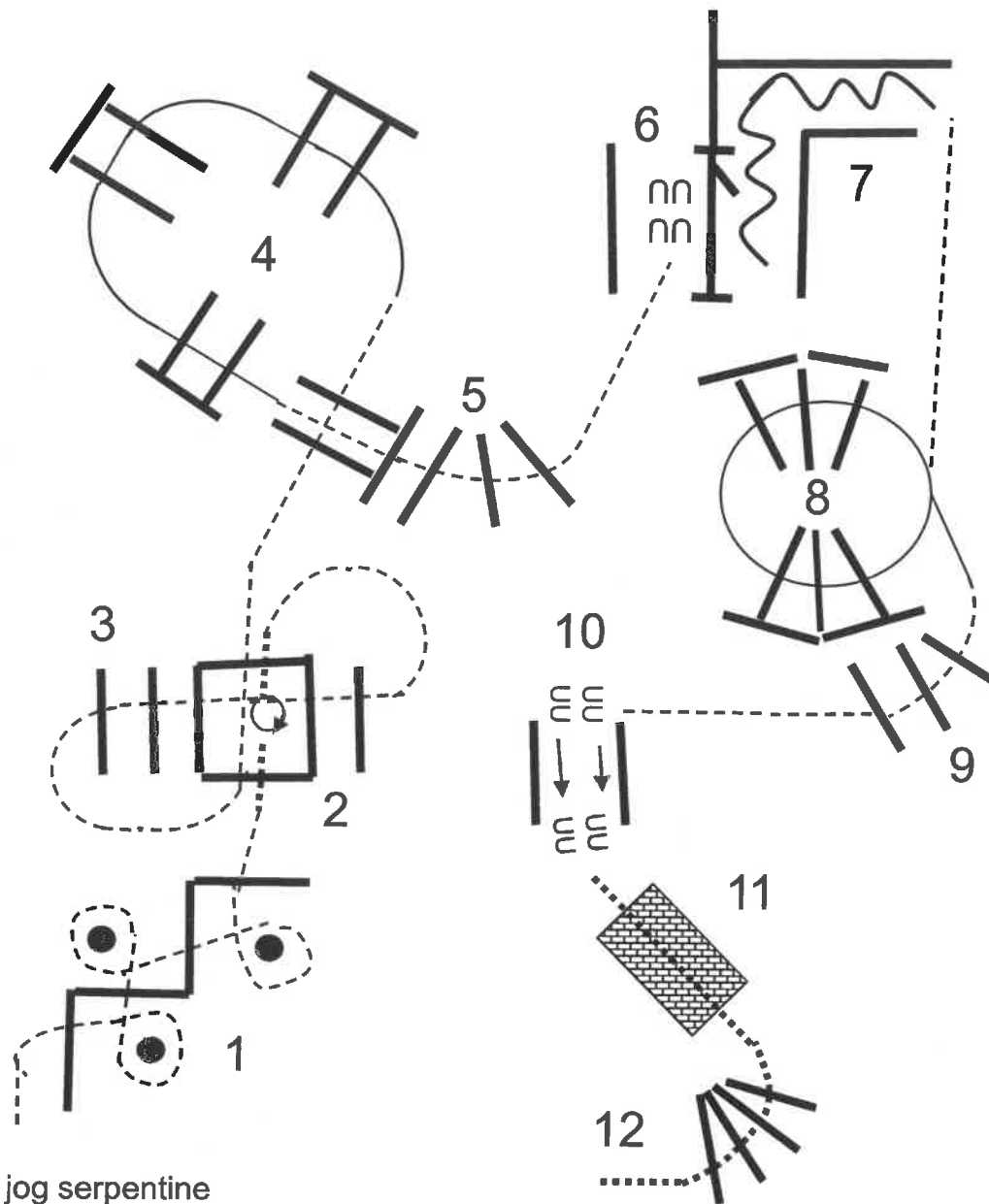

- 1 jog serpentine
- 2 walk in - 360° right - walk out
- 3 jog over
- 4 lope over left lead
- 5 jog over
- 6 gate
- 7 back up - jog
- 8 lope over right lead
- 9 jog over
- 10 left side pass
- 11 walk bridge
- 12 walk over

Lope / Galop  
 Jog  
 Walk / Pas  
 Marker -/cône

Extended Lope / Galop allongé  
 Extended Jog / Trot  
 Turn / pivot  
 Backup / reculer

# TRAIL Level 1 Open - Level 1 Amateur – Level 1 Youth

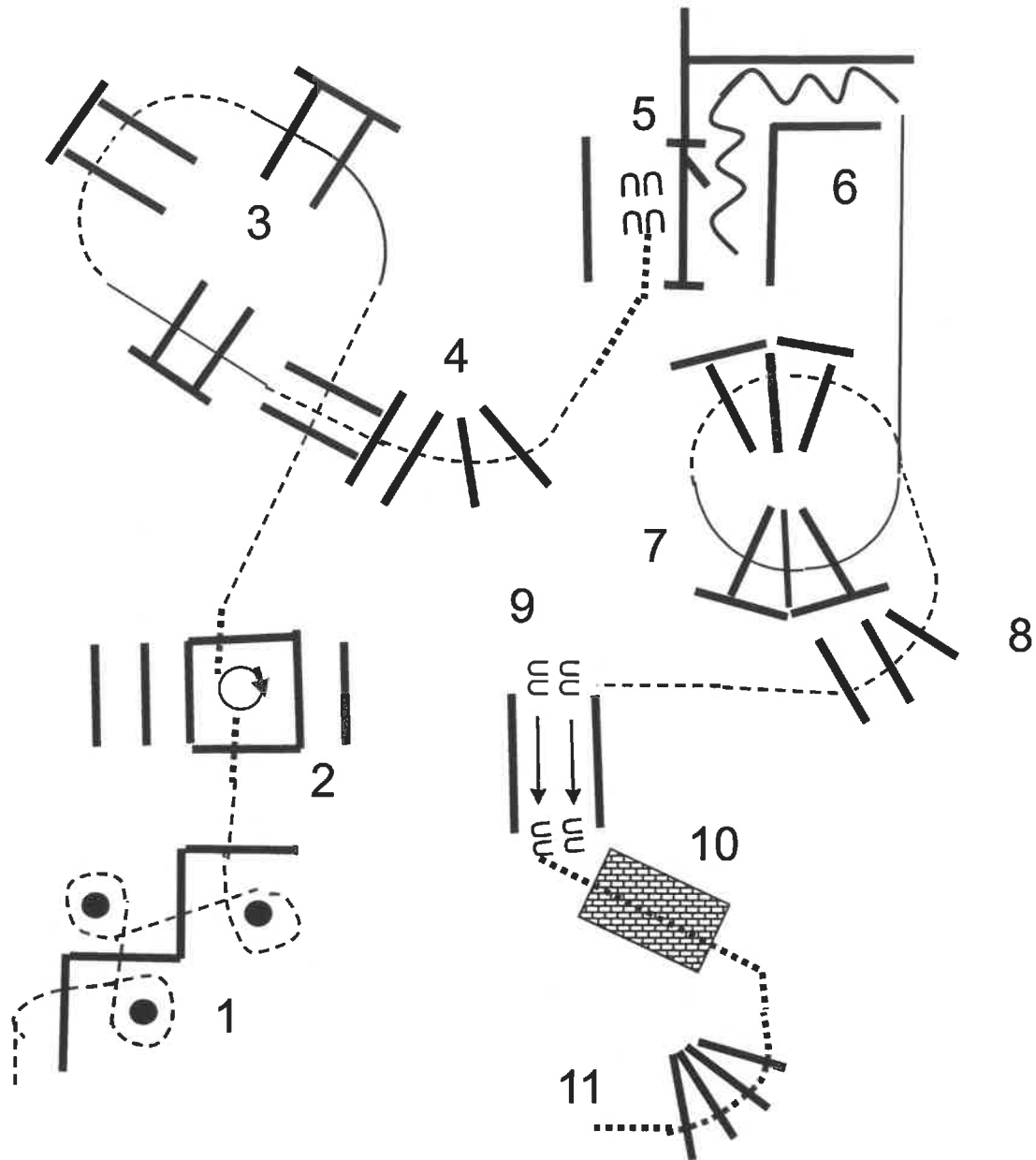

- 1 jog serpentine
- 2 walk in – 360° right- walk out
- 3 jog - lope left lead – jog – lope left lead
- 4 jog over - walk
- 5 gate
- 6 back up
- 7 lope over right lead
- 8 jog over
- 9 left side pass
- 10 walk bridge
- 11 walk over





Lope / Galop  
 Jog  
 Walk / Pas  
 Marker –/cône

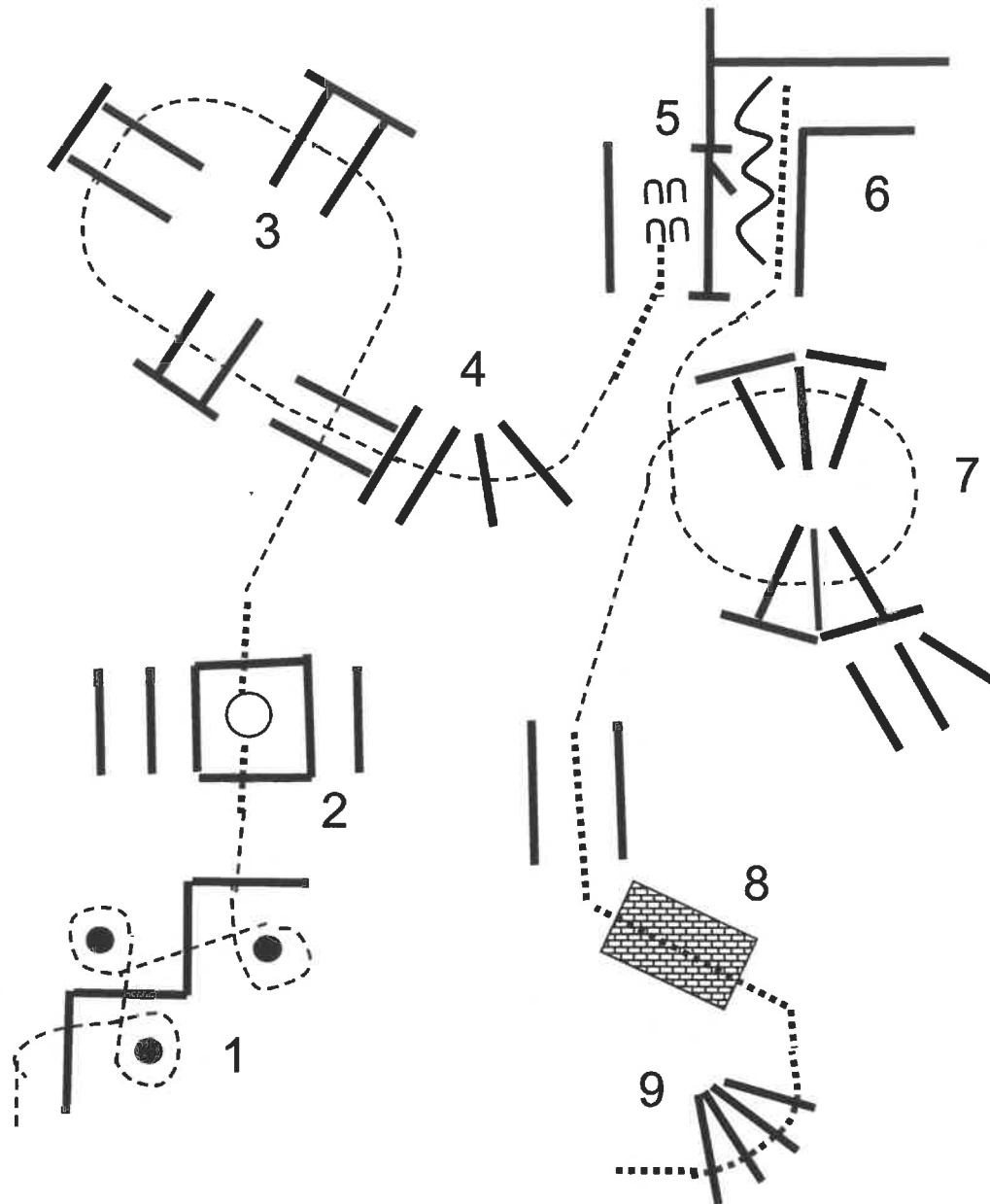



Extended Lope / Galop allongé  
 Extended Jog / Trot  
 Turn / pivot  
 Backup / reculer

# TRAIL Walk and Trot Level 1 Youth



- 1 jog serpentine
- 2 walk in – 360° either side - walk out
- 3 jog over
- 4 jog over and walk
- 5 gate
- 6 back up – walk out
- 7 jog over
- 8 walk bridge
- 9 walk over logs

 Lope / Galop  
 Jog  
 Walk / Pas  
 Marker –/cône

 Extended Lope / Galop allongé  
 Extended Jog / Trot  
 Turn / pivot  
 Backup / reculer